

Table showing the differences between the versions PX378:

PxArt+ Frame	CRI (min.)	CCT (K)	Brightness (lm)
PX378-X30	95	3000	980
PX378-930*	90	3000	1660
PX378-950	90	5000	1990
PX378-830	80	3000	2140
PX378-850	80	5000	2170

* highlighted version is available as standard, others on request

** other values are available on request

Product description

PxArt+ Frame is a professional cropping LED illuminator for the lighting of museum exhibitions or trade fair displays.

The precise cropping system allows you to control the luminous flux and adjust the illumination range to the size and position of the displayed object. Thanks to the application of the latest semiconductor COB type SSL LED light source and advanced control electronics, a high performance illuminator was made, which fulfils very high demands concerning museum exhibition and trade display lighting applications. Its most important advantages include the possibility of precise cropping of the displayed objects, total lack of ultraviolet radiation emission, traces of infrared radiation, very high colour rendering index (CRI), and very large brightness at small energy consumption.

The device features a holder allowing for its quick assembly on GLOBAL Trac® Pulse Control tracks. An individual address assigned to each illuminator allows for adjustment of brightness regardless of the settings of other illuminators.

Thanks to the press buttons located on a lamp housing, it is also possible to control the illuminators manually (e.g. in case of connecting a lamp to a frame without the control lines).

A high output LED was used in the lamp with an effective control system. Thanks to this, the lamp features small heat emission.

By using an additional PX277 device (PxArt Controller Settings), you can set all parameters of the device and read the information on the time and temperature of the lamp.

The PX378 illuminator supports the DMX-RDM protocol.

Technical Data

Type:	PX378
Power:	230 V AC
Number of LEDs:	1 (COB)
Power input:	27 W
PF (power factor)	0,94
Max. increase of the housing temp.:	+ 50° C
Luminous flux:	see table above
CRI colour rendering index:	min. 80 (see table above)
Lifetime of diodes	50 000 h
Cropping area:	max. 1,35x1,35 m (at distance 3m)
Brightness regulation extension:	0-100%
Control protocol:	DMX-512 / RDM
Available housing colours:	Grey, black or white
Weight:	2,3 kg
Dimensions:	Width: 113,5 mm (270 mm dla poziomej głowy reflektora) Height: 421 mm Diameter of the reflector: 87 mm

Manual control push buttons and lamp parameter setting socket

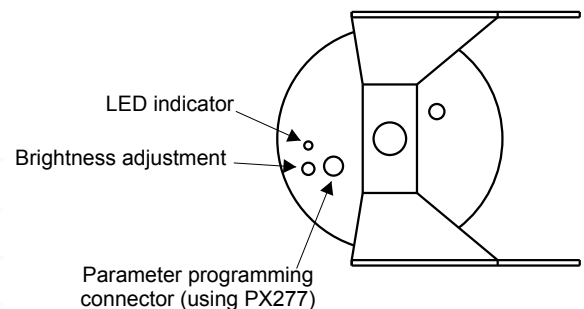

Programmed scenes:	1
Number of control channels:	1 (brightness)
Fixing:	GLOBAL Trac® Pulse control bus bar
Manual control:	yes
Signal control lamp DMX-512:	yes
Individual channel addressing function:	yes

Technical drawing

Connection diagram

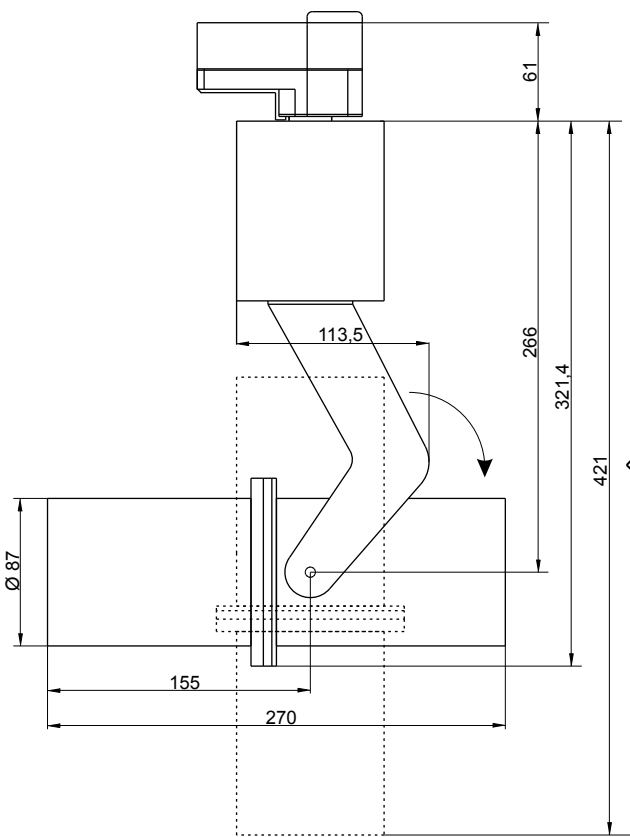

Dimensions in millimetres

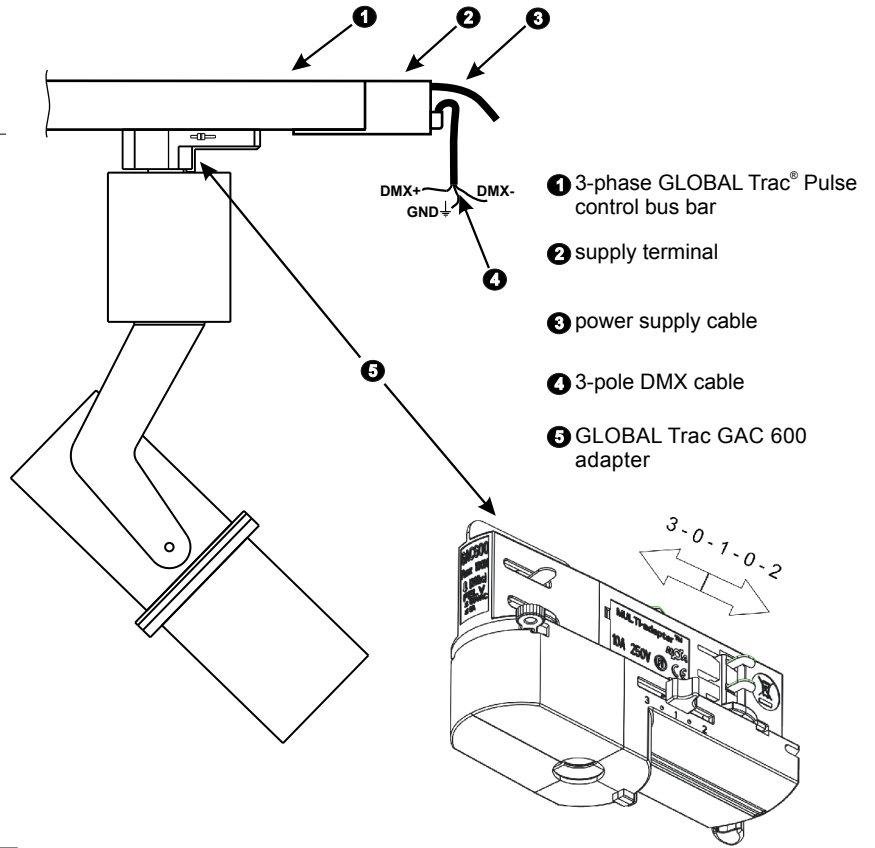

Cropping area

Light parameters:

