



DATA SHEET

PX703

Touch Panel 10"

Device description

A PX703 Touch Panel 10" has been created for communication with the PX340 / PX340+ and PX710 / PX710+ controllers. From the level of touch panel you can manage configurations that were previously uploaded to the controller.

From the device you can:

- turn on and off scenes and programs
- trigger events
- display statuses
- modify master value

To be able to communicate with the controller directly from the touch panel, it is necessary to create user accounts with appropriate access rights and the appropriate controller configuration via the PxDesigner application (description of creating the configuration was placed in the PxDesigner manual available on the manufacturer's website).

Touch Panel 10" can be powered by 12 – 24V DC voltage, in addition it has the ability to power PoE (Power over Ethernet) in the IEEE 802.3af standard, which allows you to power the device via twisted pair without using an external power supply while transferring data.

The PX703 is equipped with a 10.1" TFT IPS capacitive touchscreen display with a resolution of 1280 x 800px. The display is designed to work with up to 10 touch points.

The device has a plastic and aluminum housing, has been designed for flush mounting (wall installation).

Technical drawing

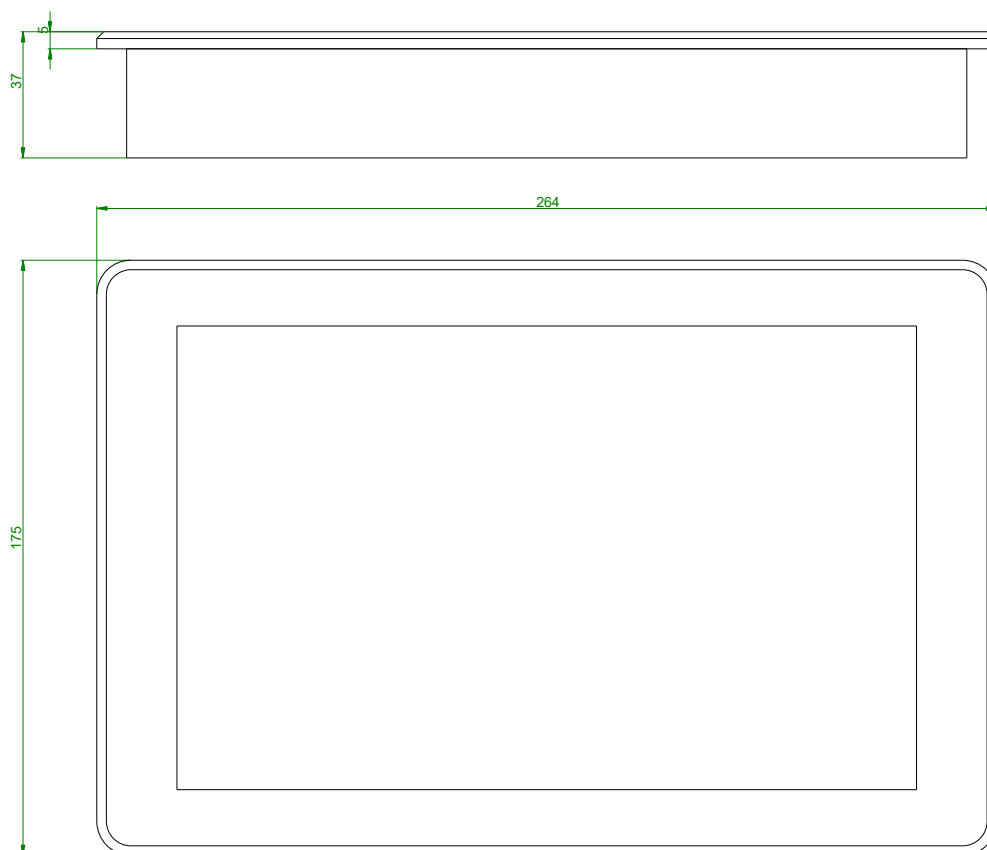

Connection diagram

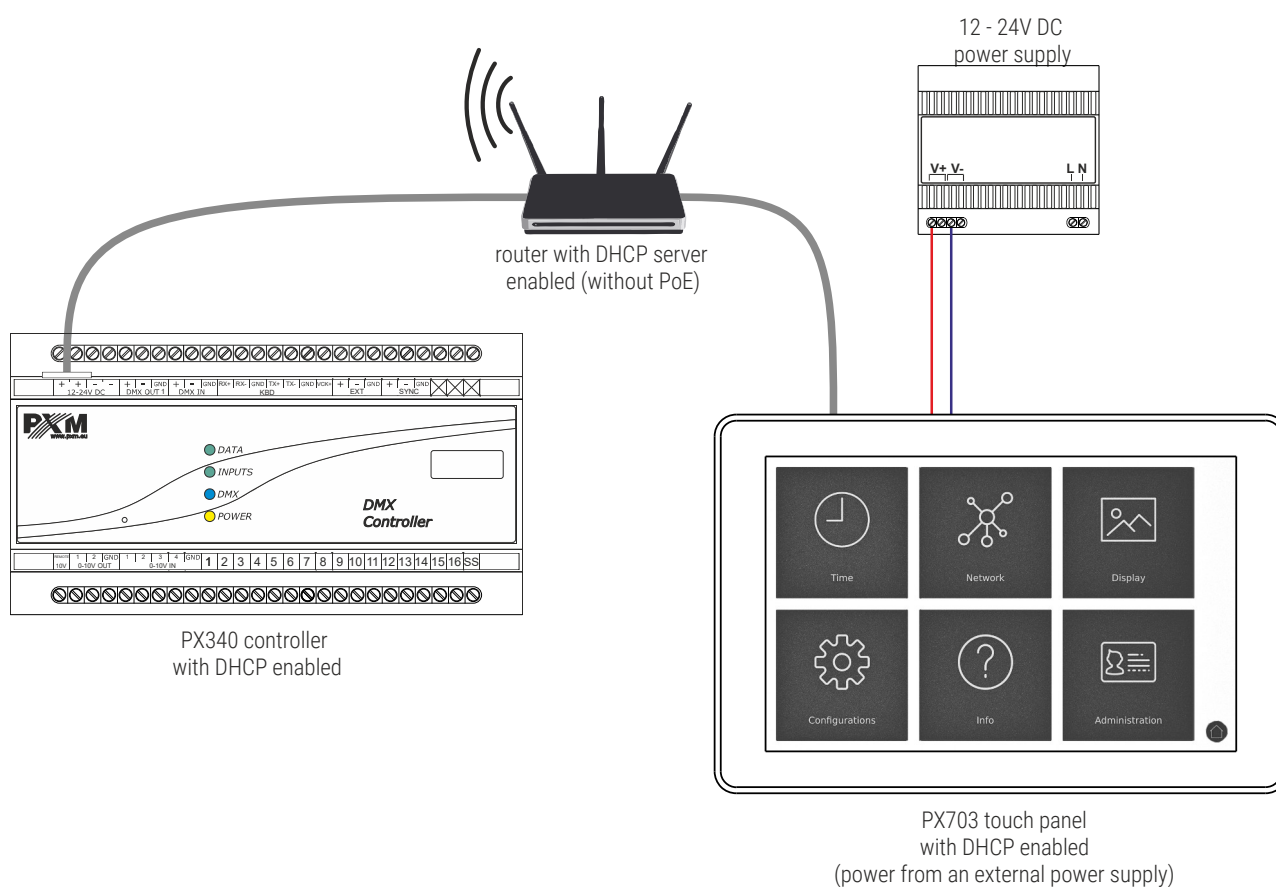

Technical data

type	PX703
display	TFT IPS 10.1" 16:9 capacitive (up to 10 touch points)
screen resolution	1280 x 800px
power supply	12 – 24VDC or PoE (Power over Ethernet IEEE 802.3af)*
housing	aluminum / plastic
connectors	1 x USB 1 x Ethernet (PoE)
buttons	1 x reset button
DHCP protocol support	yes
max. current consumption	11W
weight	1.1kg
dimensions	length: 264mm width: 175mm depth: 37mm

* - it is recommended to use only one type of power supply at a time (12 – 24V DC or PoE)